



QMW 4000

MONOWIRE

FOR CUTTING AND
SQUARING BLOCKS
OF NATURAL STONE



PERFORMANCES

QMW 4000



EXCELLENT STABILITY

A great advantage of the new monowire **QTEQ-BIDESE QMW 4000** is the [great stability](#).

Made of well-sized metal structure.

The sliding guides are machined to obtain [maximum cutting precision](#).



CIRCUIT OF DIAMOND WIRE

The new Monowire **QTEQ-BIDESE QMW 4000** has been designed with a ring system on transmission by two main pulleys with a diameter of over 2 meters, so as to [minimize the stress of the wire](#).



PULLEYS

Thanks to the two large-diameter pulley, [the life of the wires](#) is lengthened moreover an [le optimized cutting performances](#).

The high cutting precision is guaranteed by special pulleys for driving of the diamond wire.



PNEUMATIC WIRE TENSIONER

Monowire **QTEQ-BIDESE QMW 4000** is equipped with [pneumatic tensioning](#) of the wire high [effective and reliable](#), offers others [important advantages](#), such as avoiding the occurrence of the typical problems of ovalization, deviation of the cut and diamond wire breaks.

Pneumatic tensioning [eliminates the maintenance](#), as well as a positive impact of the environment thanks to the [absence of oil](#).



CUTTING SLABS PROGRAMMING (optional)

Monowire **QTEQ-BIDESE QMW 4000** can be used to produce slabs of various thicknesses in complete autonomy, thanks to the automatic movement of the block carriage and by a device to open the slabs during the wire lifting phase at the end of each cut.

The thickness setting is quick and easy by [touch screen control panel](#).

A great advantage is the [optimization of the slabs thickness](#) according to the diameter of the wire (9 - 8,5 - 7,3 - 6,3 - 5,3 - 4,3 mm), [allowing the recovering of stone](#).



TECHNICAL FEATURES

QMW 4000

QTEQ-BIDESE QMW 4000 mono-wire dimensions (LxWxH):	L: 9.000 x P: 1.230 x A: 5.100 mm
Pulleys:	∅ 2.150 mm
Guiding wire Pulleys:	∅ 700
Wire Rotation Speed:	0 - 35 metri / sec.
Cutting speed:	0 - 300 cm / h
Up-down rapid speed:	33 cm / min
Cutting area:	3.600 x H = 2.200 mm
Motor wire:	22 kw
Up-down motor:	2,2 kw
Diamond wire:	∅ 4,3 - 5,3 - 6,3 - 7,3 - 8,5 - 9 mm
Wire tensioning:	0 - 450 Kg
Required water quantity:	20 litri / min.
Required compressed air:	6 bar - 50 NL / min.
Electric power:	400 V - 50 Hz
Weight:	5.500 Kg
Diamond wire loop length:	20.600 mm
Installed electrical power:	27 kw
Transport:	n. 1 open top 40 piedi

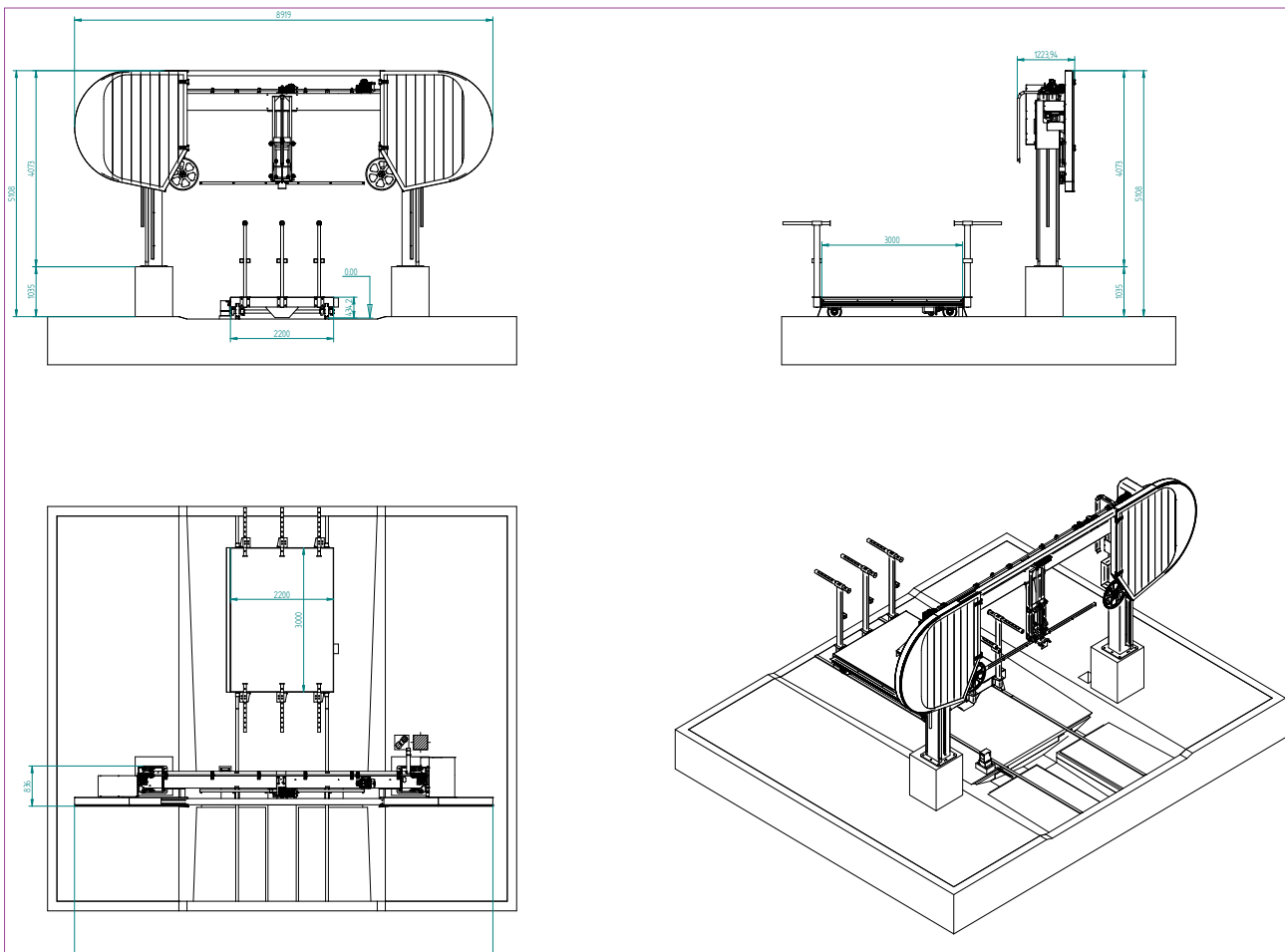



bidese_{QTEQ}

SOLUTIONS FOR
YOUR BUSINESS



QTEQ-Bidese Sp. z o.o.

Jasionka 954

36-002 Jasionka (Poland)

Tel. +48 17 77 962 75

mail: office@qteq.eu

VAT: PL5170365602

www.bidese.com

COPYRIGHT Q-TEQ 2022

The information contained in this catalog are not binding, Q-TEQ reserves the right to make changes without notice, nobody can raise any objections or claim.